

Oceanis 48.5 "Serenesse"

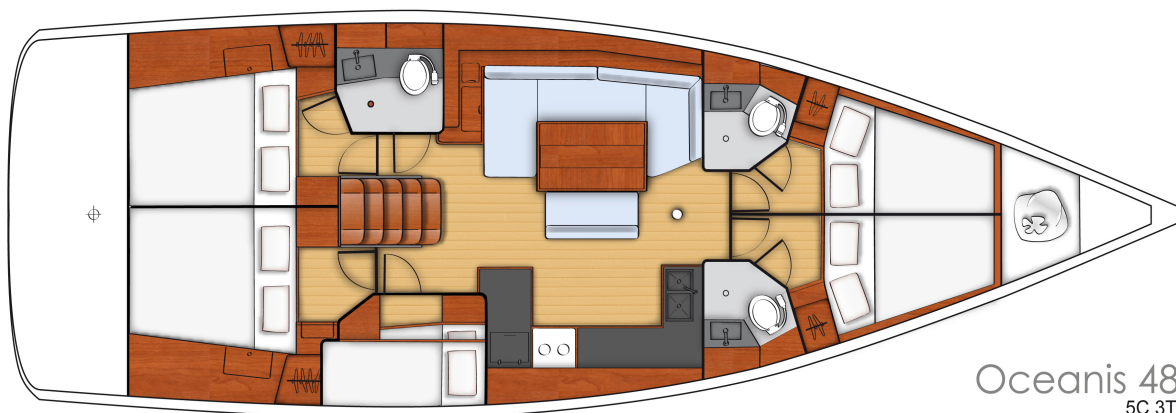

shipyard: Beneteau
launched: 2015
length over all: 14.60 m
length of the hull: 14.27 m
width: 4.74 m
draft: 1.83 m
sailarea: ca. 104,80 m²

engine 75 hp
fuel tank lt. 200
drinking water tank : lt. 690
berths: 10 + 2
cabins 5
salon: convertible
heads 3

mainsail halfsticked with lazy jack and lazy bag
furling genoa

Navigation:

Compass – Wind station - Log - Echo sounder - VHF - Binoculars - Clock - Barometer - Chart instruments – Italian Waters Pilot Handbook in English – Logbook – Bearing compass - GPS Plotter – automatic pilot

Safety:

Life raft – Safety harnesses – Life jackets – Horseshoe lifebuoy and light – Electric torch – Flare pack– smoke buoys - Electric and manual bilge pump – Fog horn - Extinguishers – First aid kit – Repair kit for engine, sails and tender– Wooden plugs - Radar reflector – Emergency tiller for wheel steering - Sheers — Halogen lamp – Scuba security float

Deck:

Electric windlass – **Bow Thruster** – Anchor with 70 m chain – Wheel – Gangway - Tender with rigid keel & two oars - Inflator – Small anchor with 15 m rope - Engine oil container– Bimini top – Spray hood - Boathook - Fenders - Emergency anchor with 50 m rope – Winch handles - Rope (1X50m; 1x25m; 3x15m) – Bosun's chair - Bathing ladder – Water hose – Water, petrol, outboard fuel tank, - Gas bottles (Gas included) - Funnel - Bucket – Deck brush – Table – Outside shower - Work gloves - Cable 220V with battery charger – Cockpit cushion – Snorkelling Fins – Cockpit speakers – Wind breaker jacket – Wind Scoop

Cabins/Galley:

Fridge - Hot water - Cooker with oven - Stereo - CD player - Pillows - Blankets – Bed linen – Towels - Cutlery - Glasses - Cups - Plates – Kitchen knives - Pots - Pans – 2 Italian espresso coffee makers – Coffee filters – Wooden spoons – Containers – Lemon squeezer - Grater – Tin opener – Bottle opener – Salad bowls – Thermos flask – Table cloth – Cabin & dining area fan