

Leopard 40 “BELLAMBRIANA”

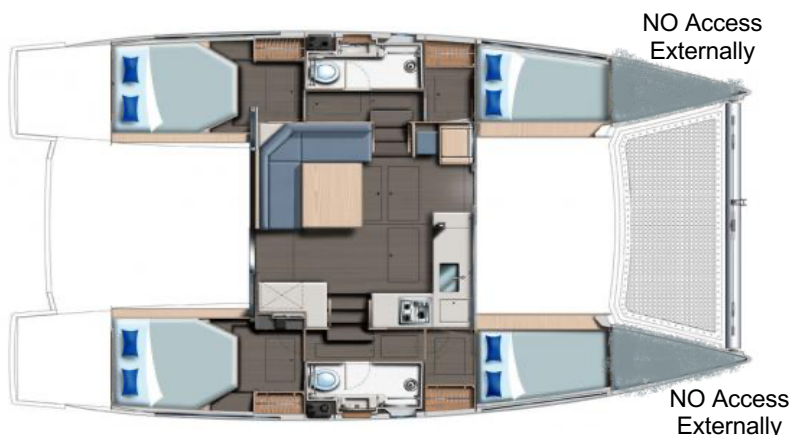

Shipyard: Robertson and Caine
Year: 2020
Length overall: 11.99 m
Waterline Length: 11.62 m
Width: 6.72 m
Draft: 1.25 m
Sail Area: ca. 96 m²
Mainsail halfsticked with lazyjack and lazybag
Furling Genoa

Engine: 2 x 29 HP
Fuel Capacity: 360 lt
Water Capacity: 780 lt
Berths: 8/10 max
Cabins: 4
Bathrooms: 2
Salon: Convertible

Navigation: Log – Echosounder – Wind Station – Autopilot – Charter Plotter GPS - VHF – Bearing Compass - Binoculars – Clock – Barometer – Chart instruments – Pilot handbook - Nautical Maps of Zone – Logbook – GPS Documents

Safety:

Liferaft – Safety harnesses – Life jackets – Horseshoe lifebouy and Light – Electric torch – Flare pack – Smoke buoys – Electric and Manual Bilge Pump – Fog horn – Extinguishers – First Aid kit – Engine, Sails and Tender Repair Kit – Wooden Plugs – Radar reflector – Emergency Tiller for Wheel Steering – Shears – Halogen Lamp – Scuba Security Float

Deck:

Electric Windlass – 1 electric winch at helm station - Anchor with 70m chain – Wheel – Gangway – Tender with rigid keel & two oars – Outboard Motor - - Inflator – Small anchor with 15m rope – Outboard Motor– Engine Oil Container – Bimini Top - Boat hook – Fenders – Emergency Anchor with 50 m rope – Winch handles – Rope (1x50m-1x25m-3x15m) – Bosuns chair - Bathing ladder – Water hose – Water, Petrol & Outboard Motor Fuel Tanks – Gas bottles (gas included) – Funnel - Bucket – Deckbrush – Table – Outside shower – Work gloves – 220V Cable with Battery Charger – Cockpit Cushion – Snorkelling Fins – Cockpit Speakers – Wind Breaker Jacket – **Solar Panels**

Galley & Cabins:

Air Conditioning – Generator - Fridge –Hot water – Electring flushing toilet – Microwave oven in galley - Cooker with Oven – Stereo - CD player – Pillows – Cultery – Glasses – Cups – Plates – Kitchen Knives – Pots - Pans – Italian Coffee Maker & Filters – Wooden Spoons – Storage Containers - Juice Squeezer – Grater – Can Opener - Bottle Opener – Salad Bowls – Thermos Flask – Table cloth – Cabin & Dining Area Fans .